



Thank you for your purchase of EchoStreams OSS212F-D5 Storage Server System!

1. Check the Content of the box. Please confirm that your package contains the following:

#	Description	Image / Description	Qty
1	OSS212F-D5 Enclosure		1
2	Motherboard	Tyan S7106GM2NR	1
3	CPU and memory	Intel Skylake and DDR4	Opt.
4	IO Cards		Opt.
5	Heatsink		2
6	2x 2.5" Drive Bay		Opt.
7	Slide Rail Kit + Screws		1 set
8	Power Cable*		2
9	Serial Cable*		1

* Inside the accessories box. Box may consist of screw sets for rail kit or drives. If any items are missing, please contact your reseller or sales rep.

2. Get Familiar with the Unit.

OSS212F-D5 is a storage server supporting dual Intel processor and front tray-less 12x 3.5" HDDs, an optional rear 2x 2.5" OS drive and 7x low profile PCIe slots in a 2U space. Tyan S7106GM2NR and internal cabling are preinstalled. Other motherboard model, IO cards, CPU, and memory can be preinstalled upon request.

Front view of the unit

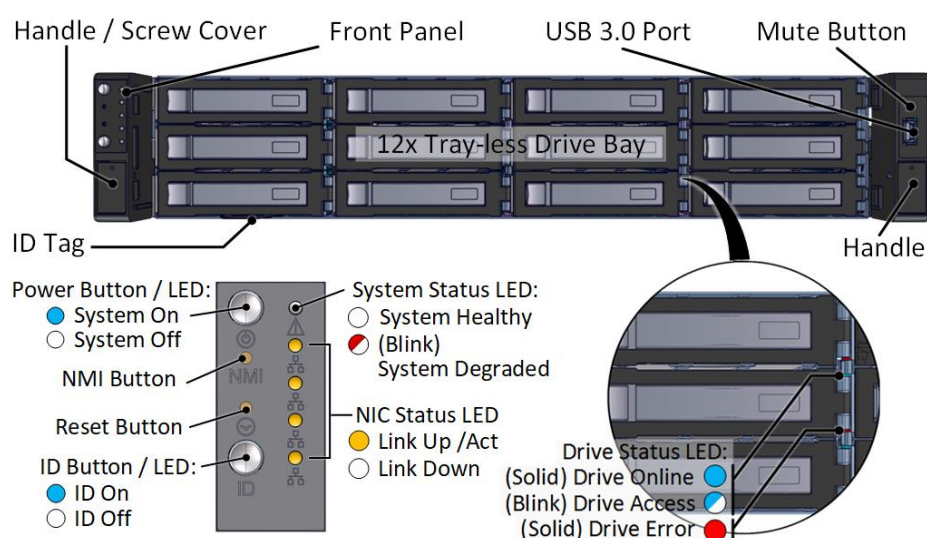

Rear view of the unit

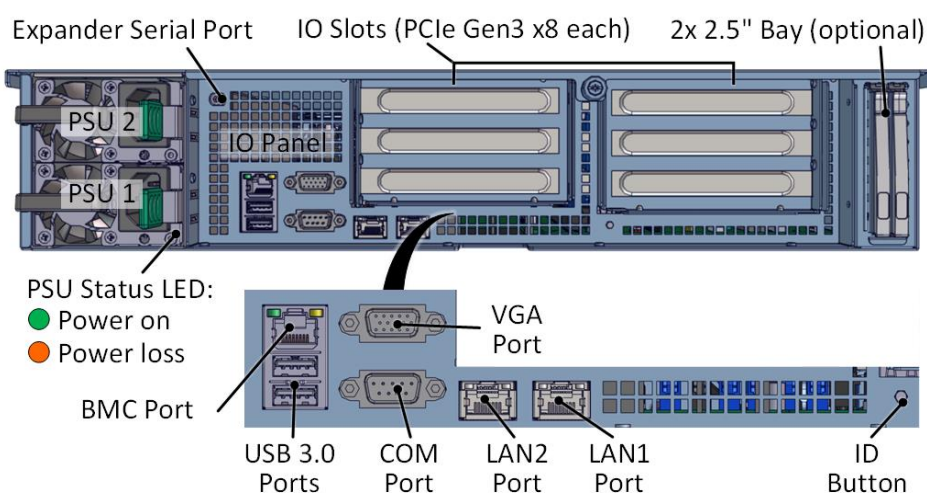

3. Remove the Top Covers of the unit as follows:

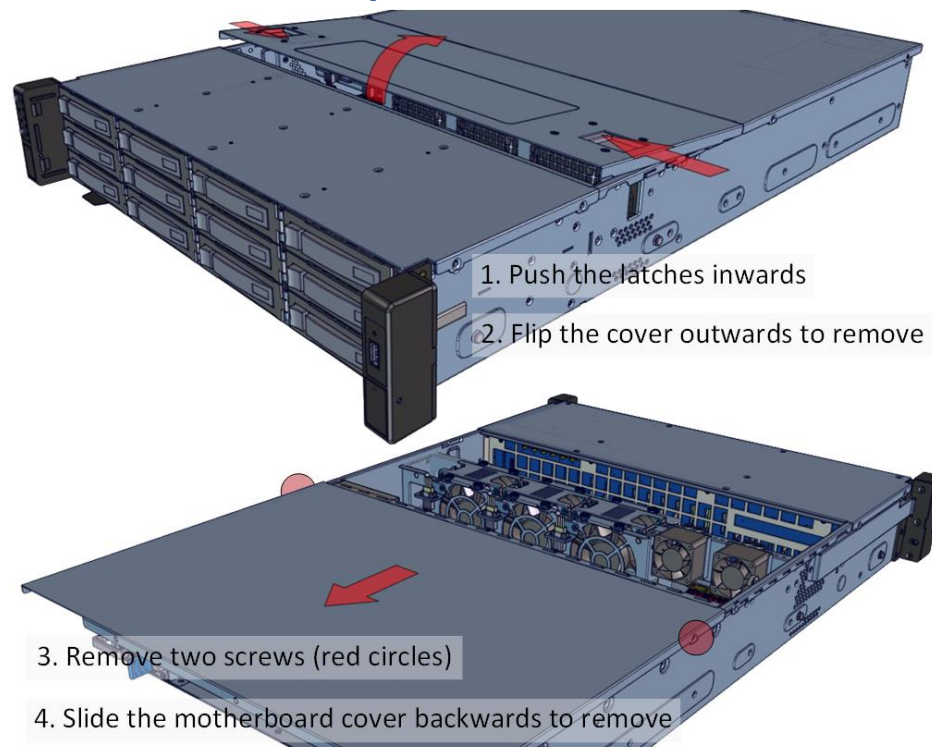

Remove the middle cover to get access to internal fans. The rear cover is for motherboard access.

4. Inspect the Inside of the unit. Internal components comprise of a Tyan motherboard, an expander board (to IO cards), an optional rear 2x 2.5" bay, 3x system fan modules and 2x IO card fan modules (all connected to the motherboard).

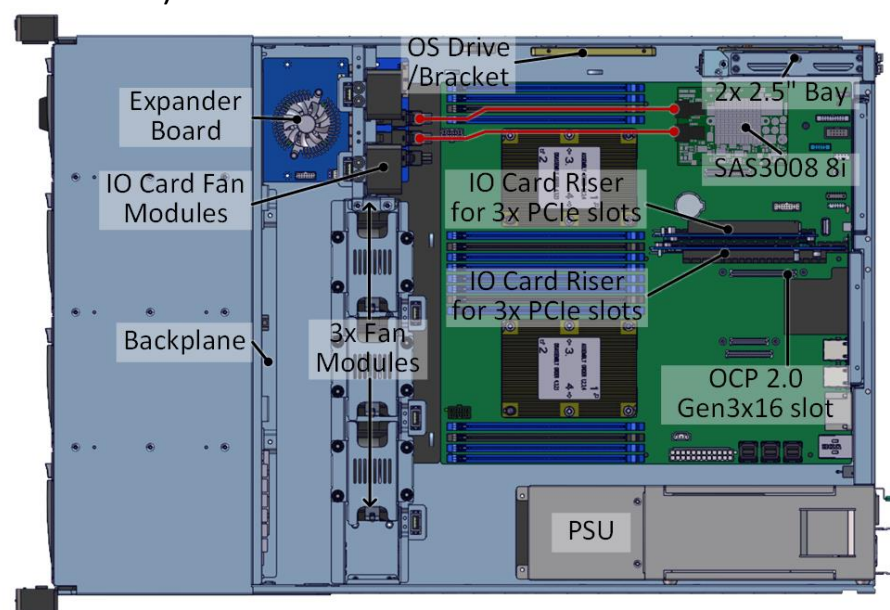

Install IO cards and OS disks as described below:



Installation and service of this product should be conducted by a trained personnel to avoid bodily injury from electric shock or heavy object



Observe ESD (Electrostatic Discharge) practices during integration to avoid possible damage to the board and / or other components

1. Remove the riser card assembly from the enclosure
2. Open the mylar top cover
3. Insert PCIe card and secure with screw

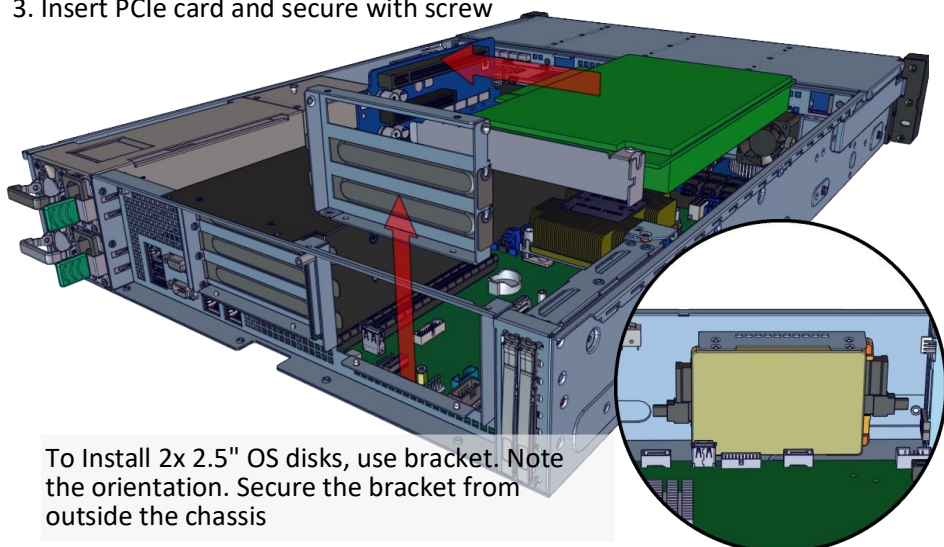

5. Install Motherboard Components.

For details, refer to the motherboard user's guide.

- Support for Intel Xeon Skylake Processor Family
- Dual LGA3647
- Max up to 205W TDP
- Chipset PCH Intel C622
- Support 8+8 DIMM slots
- Up to 512GB RDIMM, 1TB LRDIMM, 2TB LRDIM 3DS
- 6 Channels per CPU
- Populate from A0, B0, C0, D0, E0, F0, B1, E1
- Two PCIe Gen3 x24 slots
- PCIe1 f/ CPU1, PCIe2 f/ CPU0
- OCP2 is Gen3 x8, OCP1+2 is Gen3 x16, f/ CPU0
- OCP4 is Gen3 x8, OCP3+4 is Gen3 x16, f/ CPU1

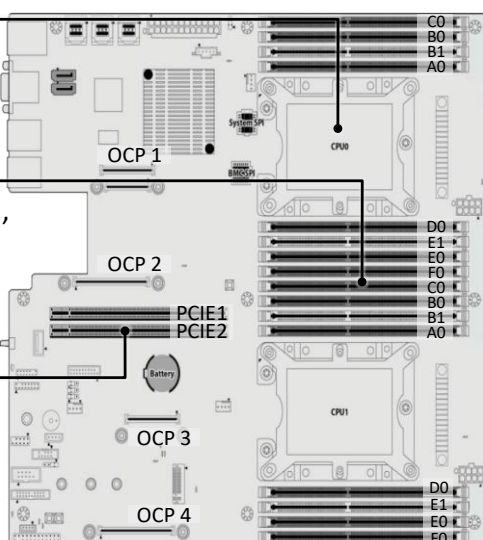

6. Remove the Inner Rail from the slide rail.

- 1-2 Pull the inner rails out. Pull the blue release tab when it hits a stop.
- 3-4 Keep extending inner rail and pull the white detach tab when it hits the second stop
- 5-6 Unretract the mid rail by pulling the latch on the mid rail

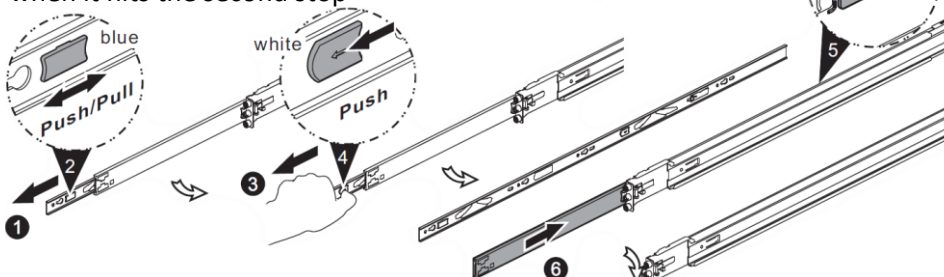

7. Install Inner Rails to the enclosure.

Yellow circles are for standoff screws

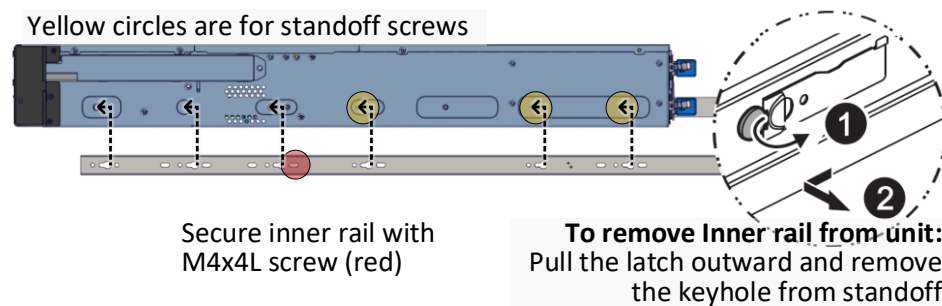

8. Install the Outer Rails to the Rack as follows:

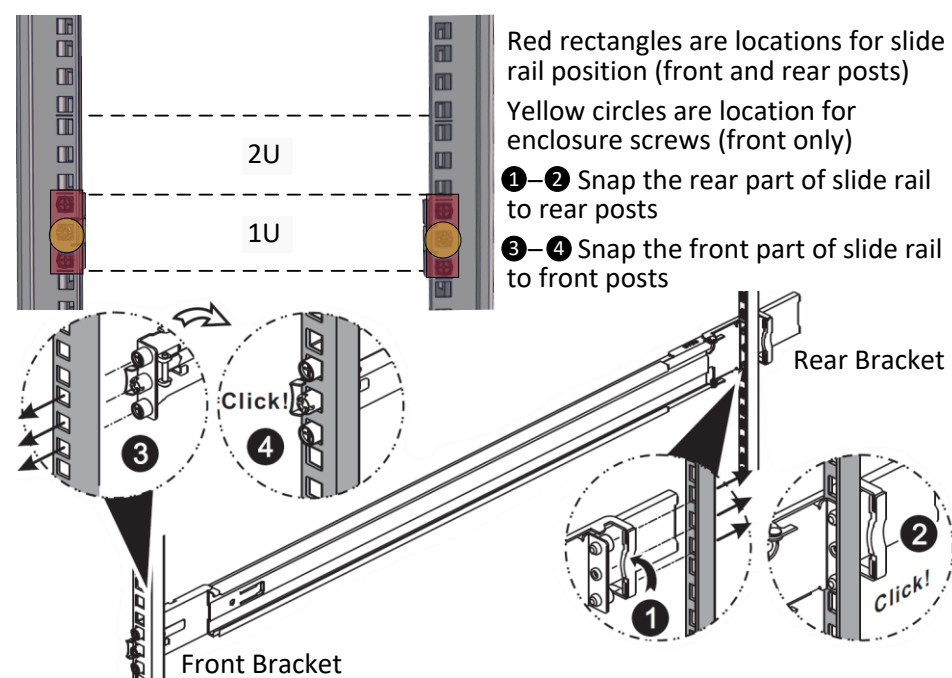

To remove slide rails, use the latches to undo the assembly as follows:

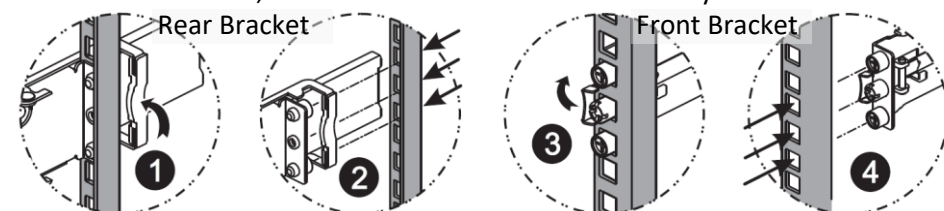

9. Install the Unit to the Rack as follows:

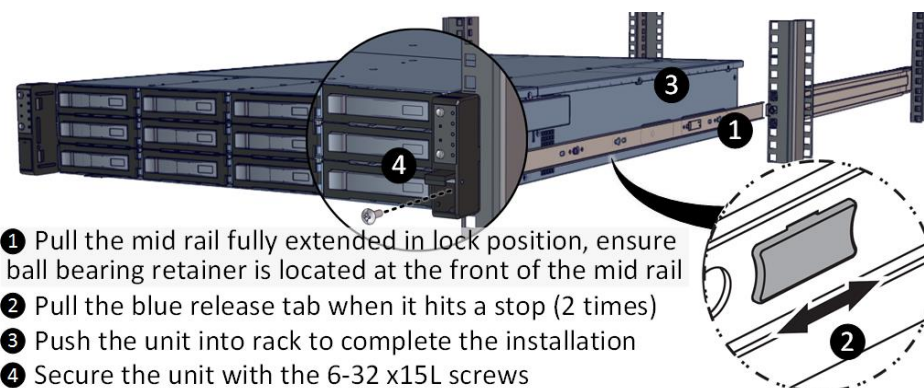

For a complete instruction on how to install unit to the rack, please follow the Slide Rail Installation Guide.



At least two people are recommended for mounting process.

10. Install 2.5" Drives to the enclosure as illustrated:

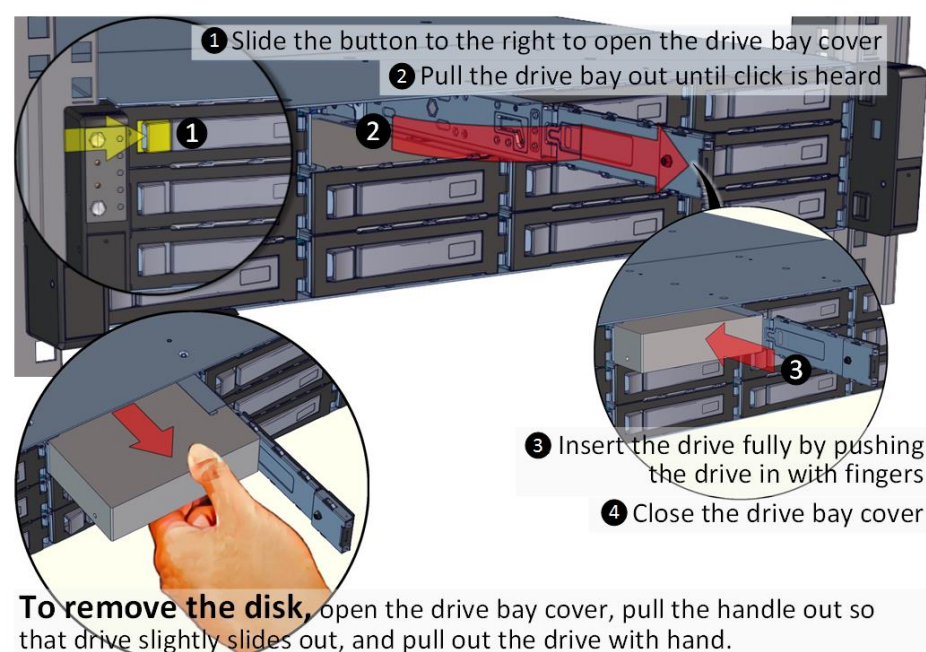

11. Drive Mapping of OSS212F-D5 is as follows:

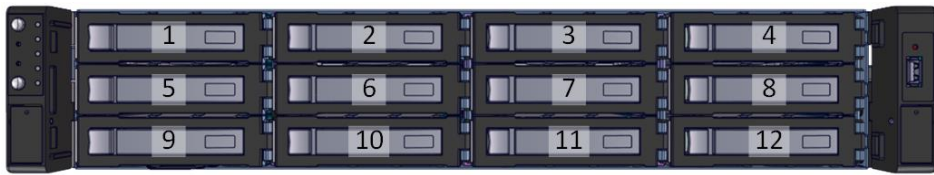

12. Plug in the Power Cords to the AC receptacles on the back of the unit.

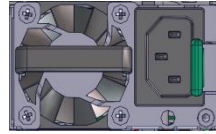

13. Press the Power Button on the front of the unit and for the system to boot up.

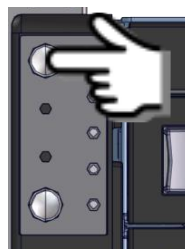

14. Access the Serial Console (when necessary) by connecting a serial audio cable to the one of the console ports. Use a terminal console with baud set 115200, 8, N, 1, N. Type “help -a” for a list of commands.

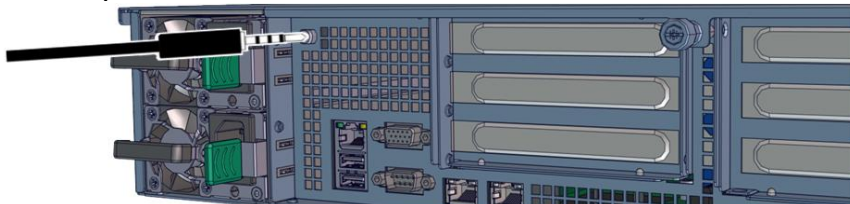

For management through Eth port, refer to the User's Guide.