



**Thank you for your purchase of FlacheSAN1L-D5, 1U 20-Bay Skylake DP Storage Server!**

**1. Check the content** of the box. Please verify that your package contains the following:

#	Description	Image / Description	Qty
1	1U20 Enclosure		1
2	2.5" Tool-less Drive Trays		20
3	Motherboard	Tyan S7106GM2NR	1
4	Internal SAS cables	Ex. SFF-8643 to Oculink	5
5	OS disk bracket		1
6	CPU and memory	Pre-installed upon request	2 sets
7	Heat sink		2
8	Screw Sets*	for drives, motherboard, and rail and rack	3 sets
9	Power Cable*		2
10	Slide Rail Kit (opt)		1
11	Front Bezel (opt)		
12	This Quick Guide		1
13	Packaging		1 set

\* Inside the accessories box. If any items are missing, please contact your authorized reseller or sales representative

## 2. Get familiar with the unit.

### Front View

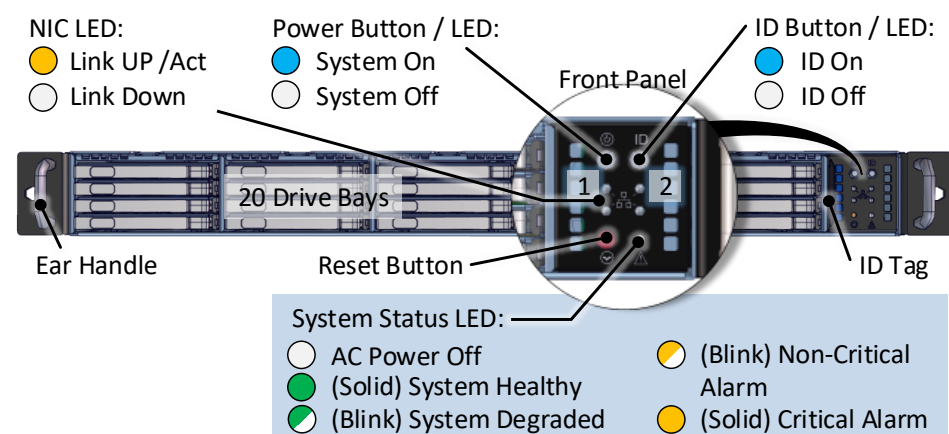

### Rear View

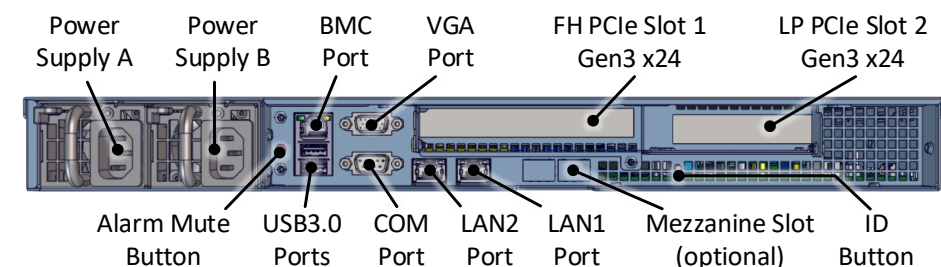

### Drive Tray

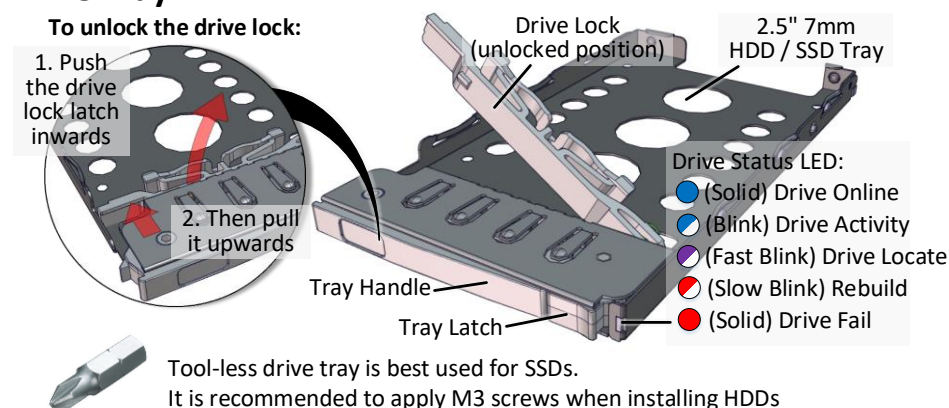

**3. Remove the top cover** by removing the 7 screws (red circles) on the top of the unit and slide the cover towards the back of the unit.

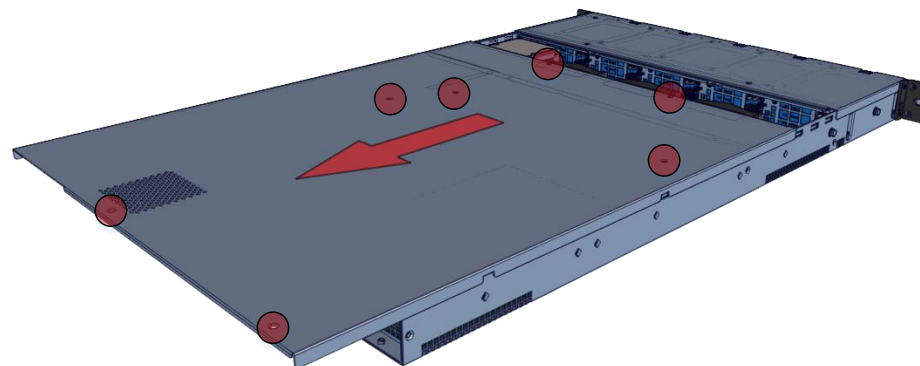

**4. Inspect the internal** of the chassis. By default, it consists of:

- Tyan S7106GM2NR Skylake Dual Processor Purley motherboard
- A set of five backplanes supporting 20x tool-less drive trays for 2.5" 7mm HDDs or SSDs
- 3x blower modules
- 2x PCIe riser cards for 2x IO cards (one low profile, one full height),
- An drive bracket for 2x 2.5" OS disks

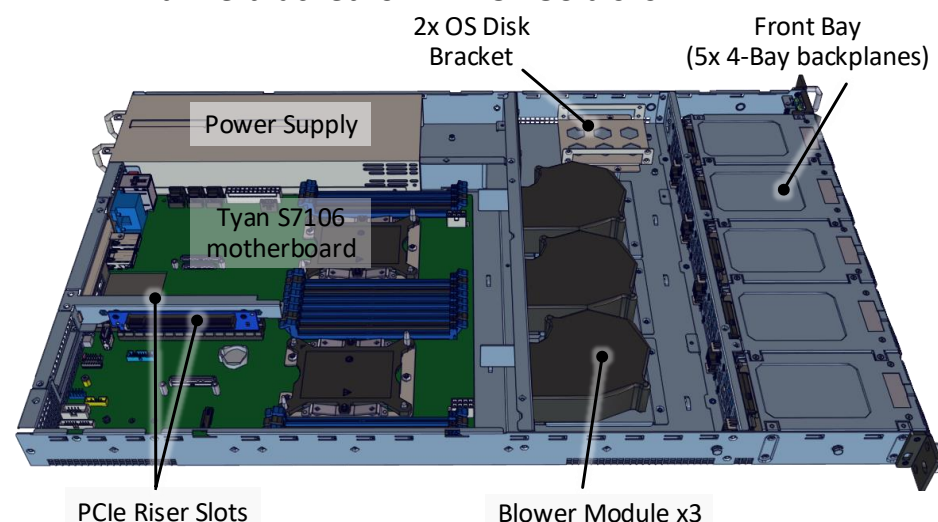

See illustration below for one example of the data path from disk devices to the host.

- OS disks are connected to the on-board Mini SAS HD connectors (SATA 3.0)
- Front 20x drives are connected to 2x SAS mezzanine cards on OCP slots

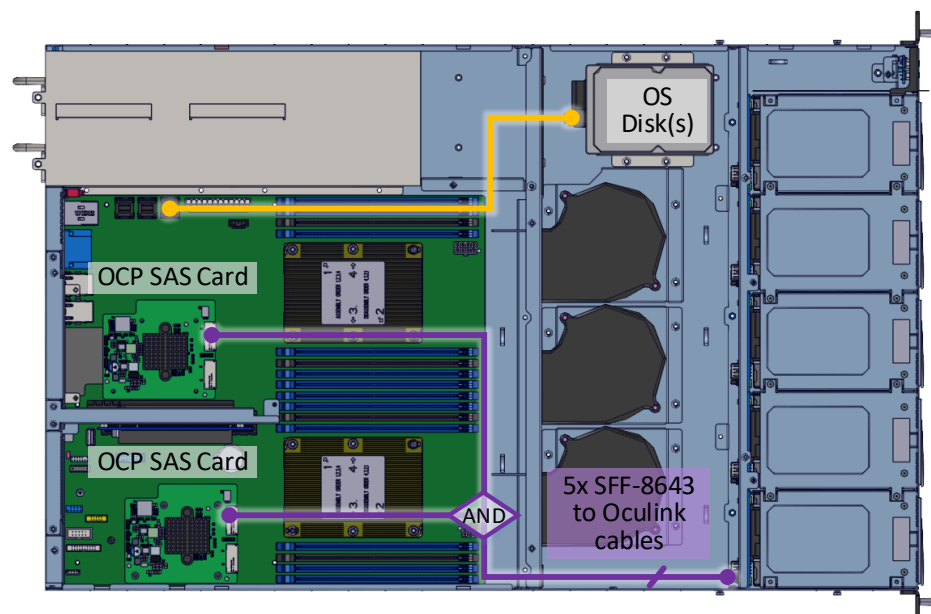

Installation and service of this product should be conducted by a trained personnel to avoid any bodily injury from electric shock or heavy object



Observe ESD (Electrostatic Discharge) practices during integration to avoid possible damage to the board and / or other components



**5. Install CPU and memory** (may be sold separately) to their respective slots on the motherboard. Refer to the motherboard's TPS for details.

- Support for Intel Xeon Skylake Processor Family
- Dual LGA3647
- Max up to 205W TDP
- Chipset PCH Intel C622
- Support 8+8 DIMM slots
- Up to 512GB RDIMM, 1TB LRDIMM, 2TB LRDIM 3DS
- 6 Channels per CPU
- Populate from A0, B0, C0, D0, E0, F0, B1, E1
- Two PCIe Gen3 x24 slots
- PCIe1 f/ CPU1, PCIe2 f/ CPU0
- OCP2 is Gen3 x8, OCP1+2 is Gen3 x16, f/ CPU0
- OCP4 is Gen3 x8, OCP3+4 is Gen3 x16, f/ CPU1

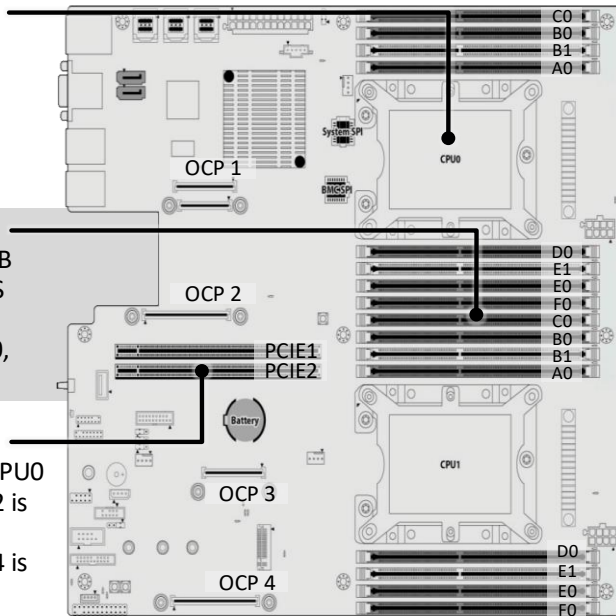

**6. Install OS disk(s)** into the bracket.

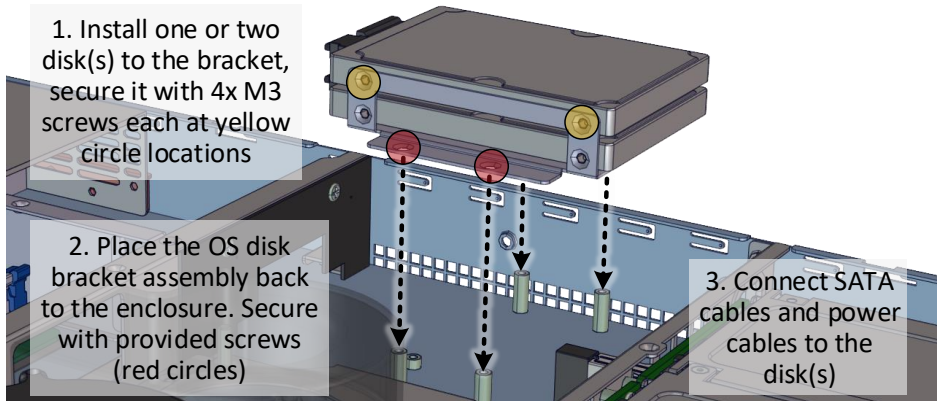

**7. Install IO cards** (may be sold separately) to PCIe slots.

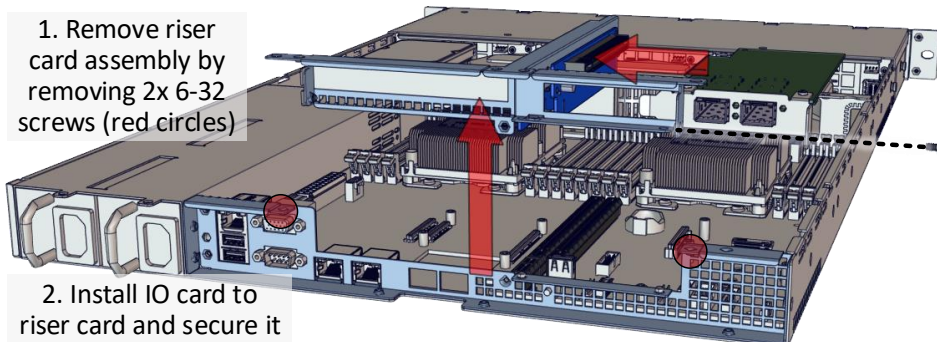

**8. Replace the top cover.** Once we are finished with the internals of the system, close the top of the chassis as described below:

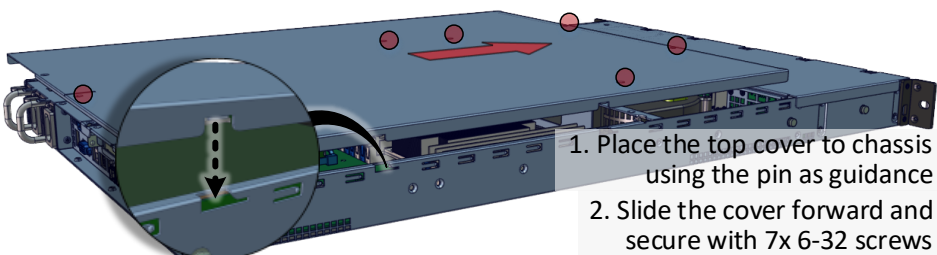

**9. Remove drive trays** from the enclosure.

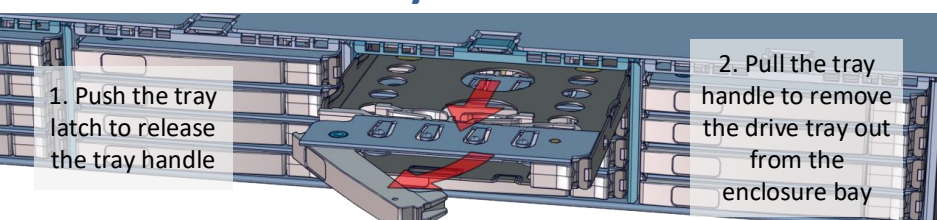

**10. Install drives into trays.** Follow the diagram closely. SSD and HDD sold separately. For HDD installation, the use of M3 screws is recommended.

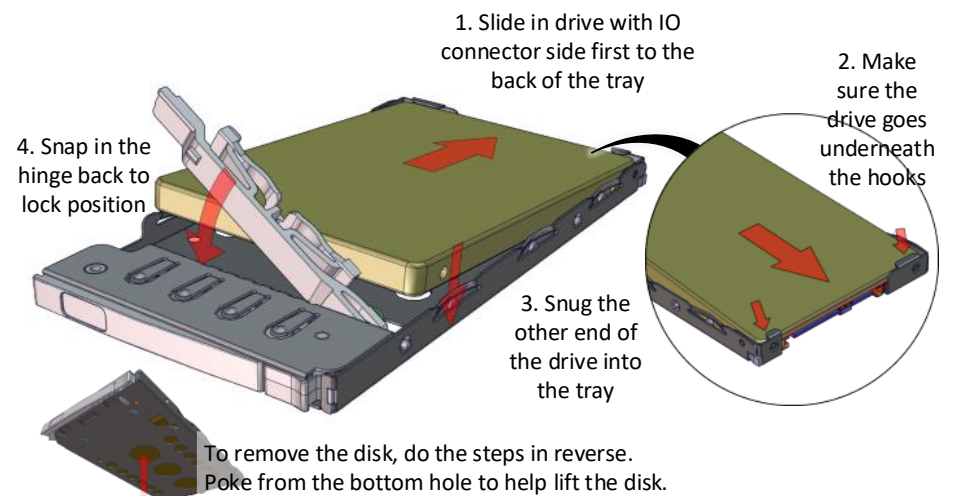

**11. Place the unit to the rack.** Two types of slide rail (22" and 28" long) are available. Secure with screw as indicated. Please refer to Rail Kit Installation Guide on how to mount the enclosure to the rack.

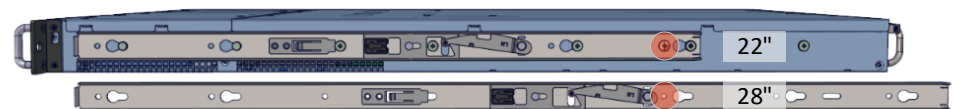

**12. Install the populated drive trays** into the enclosure with the drives properly secured to the hard drive trays.

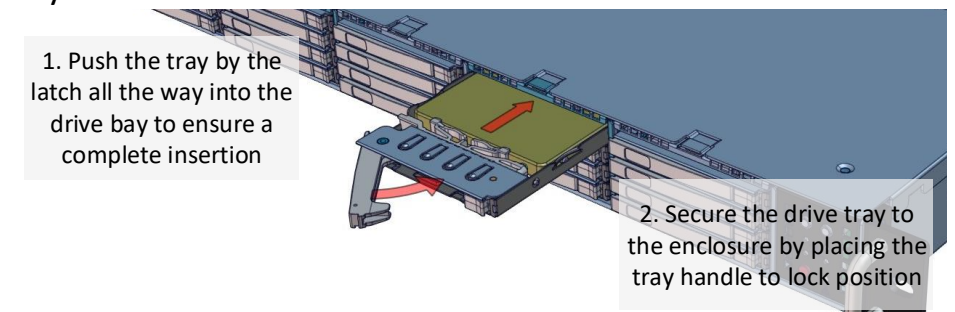

**13. Drive mapping** begins from top to bottom and to the right, depending on the internal SATA connection.



**14. Plug in the power cords** to the AC receptacles on the back of the unit and secure it with power cable harness.

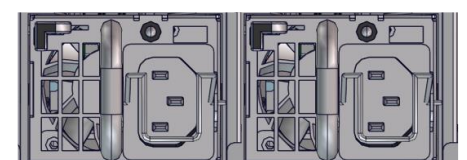

**15. Press the power button** on the front of the unit after connecting a monitor and input devices, and get ready for software setup.

